

RATED VALUES							STARTING VALUES				BREAKDOWN	EFFICIENCY			EFFICIENCY CLASS			
VOLTAGE	POWER		SPEED	CURRENT	TORQUE	Cos φ	CURRENT		TORQUE		TORQUE	%			IEC 60034-30-1			
V	kW	Hz	rpm	A	Nm	4/4	I _A / I _N	Y	D	M _A / M _N	Y	D	Mk / Mn	Nm	4/4	3/4	2/4	IE
110/190	0,75	60	1734	6,1/3,5	4,1	0,78	6,4			2,4			3,5		IE3-83,5	83,3	80,8	IE3

Mechanical Data

<i>Bearing DE</i>	6204-ZZ	<i>Color</i>	RAL 6011
<i>Bearing NDE</i>	6204-ZZ	<i>Motor protection</i>	No
<i>Lubricants</i>	Shell Gadus S2 V100Q2	<i>Method of cooling</i>	IC 411
<i>Condensation drain hole</i>	No	<i>Terminal box position</i>	Top
<i>External earthing terminal</i>	Yes	<i>Material of terminal box</i>	Aluminium
<i>Vibration class</i>	A	<i>Terminal plate thread</i>	M4
<i>Insulation class</i>	F	<i>Cable gland</i>	1xM20
<i>Duty type</i>	S1	<i>Clamping range</i>	13-18 mm
<i>Direction of rotation</i>	Clockwise	<i>Mounting type</i>	IM 1001 (B3)
<i>Housing material</i>	Aluminium		
<i>Type of balancing</i>	Half Key		

Environmental Data

Others

<i>Ambient temperature</i>	-20 / + 40 °C	<i>Type of protection</i>	IP 56
<i>Altitude above sea level</i>	1000 m	<i>Sound pressure level</i>	dBA 52
		<i>Moment of inertia (kg.m²)</i>	0,0026099
		<i>Standard</i>	IEC 60034-1
		<i>Weight (kg)</i>	12

Dimensions

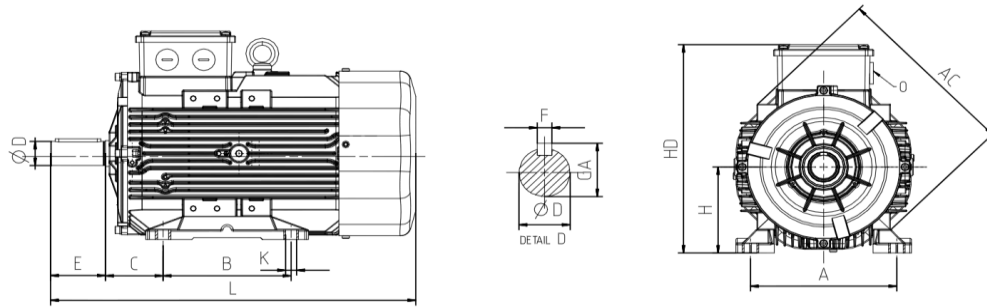

Main Dimensions		Foot Mounted Motors						Shaft				Flange Mounted Motors			
AC	L	B	A	H	HD	K	C	D	E	GA	F	P	N	M	R
158	268	100	125	80	212,5	10	50	19	40	21,5	6	-	-	-	-